

County Trunk Highway B

(East 796.00')
N88°45'19"E 796.00'

(66' Wide)

East 1/4 Corner
Section 29-1-17
N. 191.882.00
E. 2,404.039.87

Property Exhibit

of

A Portion of Tax Parcel IA196400001,

located in the Southeast 1/4 of Section 29, Town 1 North, Range 17
East, Town of Linn, Walworth County, Wisconsin.

Prepared for: **Conserve FS**
W4147 County Road B
Zenda, Wisconsin. 53195



Bearings reference to the Wisconsin State
Plane Coordinate System, South Zone.

Tax Parcel
IL 2900001A

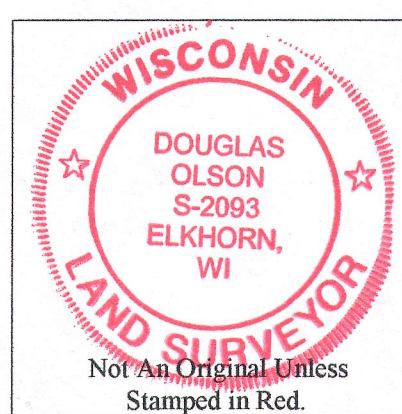

Not An Original Unless
Stamped in Red.

Notes:

- 1) This Property Exhibit is not an original unless signed and sealed in red ink.
- 2) This exhibit is subject to Wisconsin lien laws. This Property Exhibit is the notice of intent to file lien. Lien waiver required.

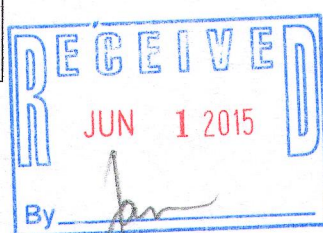

Copyright 2013 by Jensen & Olson Land Surveying, LLC.

All rights reserved. No part of this survey plat may be reproduced or transmitted in any form by any means - graphic, electronic, or mechanical, including photocopying, tracing, or information storage and retrieval systems - without permission in writing from Douglas G. Olson, Jensen & Olson Land Surveying, LLC.

I, Douglas G. Olson, Wisconsin Registered Land Surveyor, do hereby certify that this survey was performed by me, or under my direction in full compliance with the owner's/agent's instructions and Chapter A-E 7 of the Wisconsin Administrative Code "Minimum Standards for Property Surveys"; and that this map is an accurate representation thereof to the best of my knowledge and belief.

Douglas G. Olson
Wisconsin Registered Land Surveyor - 2093

(North 384.35')
N1°13'54"W 384.44'
351.44'

Split Rail
Fence

Tank

Tank

Tank

Tank

Tank

Tank

Metal
Containment
"Box"

Existing
Building

Tax Parcel
IA196400001
(7.03 Acres)

S88°44'49"W 798.03'
(West 797.90')

2013.023

Sheet 1 of 1 Sheets

Drawing Name:

Job Reference Number

2013.023

Legend

- Found County Section Corner
- Found Iron Pipe
- Found Iron Rod
- Recorded Information
- Utility Pole
- Bollard
- Concrete Surface
- Gravel Surface



Jensen & Olson Land Surveying, LLC

45 South Wisconsin Street * P.O. Box 322 * Elkhorn, Wisconsin. 53121

Telephone: (262) 723-3434 * Facsimile: (262) 723-8044

Email: jensen.olson@elknet.net

Scale in Feet
1" = 20'

0' 10' 20' 40'

Survey Date: April 30, 2013.
Revisions:

IA1964-1 117-3787